

ENGINE LUBRICATION SYSTEM

9210-01

OVERVIEW AND OPERATION PROCESS

1. ENGINE OIL CIRCULATION

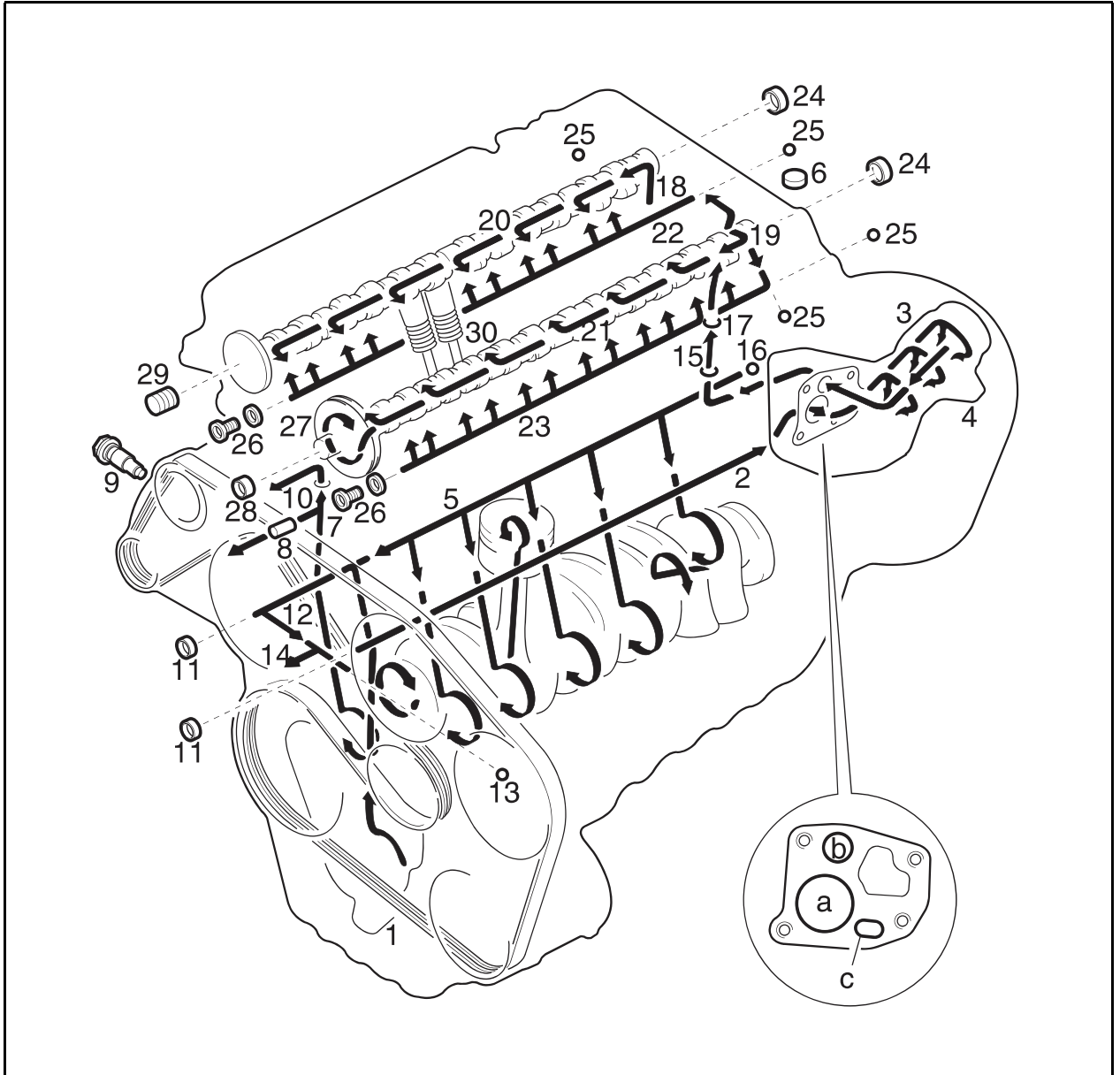

Modification basis	
Application basis	
Affected VIN	

► OIL CIRCULATION

NO.	FUNCTION	NO.	FUNCTION
1	Oil pump	18	Oil supply (to exhaust camshaft)
2	Oil gallery (to oil filter)	19	Oil supply (to intake camshaft)
3	Oil filter	20	Oil supply (to exhaust camshaft bearing)
4	Oil pressure switch	21	Oil supply (to intake camshaft bearing)
5	Main oil gallery	22	Oil gallery (oil supply to exhaust valve tappet)
6	Cylinder head closing cover	23	Oil gallery (oil supply to intake valve tappet)
7	Oil gallery (at chain tensioner)	24	Camshaft closing cover
8	Oil non-return valve	25	Ball (ϕ 8 mm)
9	Chain tensioner	26	Screw plug
10	Vent (chain tensioner)	27	Camshaft adjuster
11	Front closing cover (ϕ 17 mm)	28	Front closing cover (intake camshaft)
12	Oil gallery (perpendicular to the shaft)	29	Front treaded bushing (exhaust camshaft)
13	Ball (ϕ 6 mm)	30	Valve tappet
14	Oil spray nozzle (timing chain)	a	Oil gallery (from oil pump to oil filter)
15	Oil gallery (at cylinder head)	b	Main oil gallery
16	Ball (ϕ 15mm)	c	Oil return line (oil returns to the oil pan when replacing the filter element)
17	Oil restriction inner (ϕ 4mm)		